



LTC 9385 Series Housings Outdoor



- ▶ For 1/3-inch, 1/2-inch, or 2/3-inch format CCD cameras
- ▶ All aluminum construction
- ▶ Easy installation
- ▶ Removable cover
- ▶ Built-in window heater/defogger
- ▶ Accessories available

The LTC 9385 Series of medium-sized environmental housings are attractive aluminum enclosures designed for outdoor CCD camera installations. These housings are constructed of an extruded aluminum cover and a fabricated aluminum frame. The unique design allows adjustments to be made to the camera in its mounted position, once the cover is removed. The cover contains a polycarbonate window that is UV stabilized. An internally mounted thermostatically controlled heater is standard. The heater design minimizes fogging of the window in high humidity areas, or freezing under cold temperature conditions. The rear of the housing contains three liquid-tight fittings which permit pass-through of video coax, AC power, and lens control wiring. The housing is sealed with O-rings. The mounting base assembly permits mounting to pan/tilts, adjustable heads, and various wall-mounts. A unique feature of this housing is an internal rail assembly that rotates independently of the mounting base assembly, and allows the camera to be mounted at any angle.

Installation/Configuration Notes

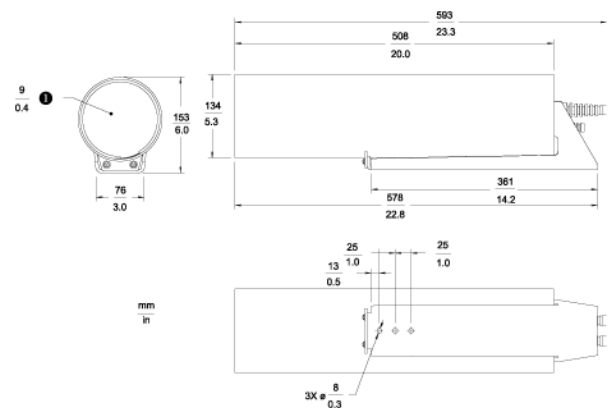

Dimensional Outline LTC 9385 Series

1 Thick

Parts Included

| Quantity | Component |
|----------|----------------------------------|
| 1 | LTC 9385 Series Outdoor Housings |

Technical Specifications

Electrical

| Model No. | Rated Input | Voltage Range | Nominal Power ¹⁾ |
|-------------|---------------------|------------------|-----------------------------|
| LTC 9385/60 | 115 VAC 50/60 Hz | 108 to 132 VAC | 50 W |
| LTC 9385/20 | 24 VAC 50/60 Hz | 21.6 to 26.4 VAC | 50 W |
| LTC 9385/50 | 230 VAC 50/60 Hz | 207 to 253 VAC | 50 W |

Electrical Connections Three position terminal block for supply line power. LTC 9385/60 and LTC 9385/50 models have inline receptacles for camera power connections.

Heater-Defogger Standard 40 Watt thermostatically controlled heater/defogger

1) Heater requires 40 watts.

Mechanical

Maximum Camera/Lens Size Accepts cameras up to 102 W x 71 H mm (4.0 x 2.8-inch), lenses up to 102 W x 92 H mm (4.0 x 3.6-inch), and camera/lens combinations up to 345 L mm (13.6 inch).

Cable Entry Two (2) 1/2 -inch NPT and one (1) 3/8-inch NPT tapped holes. Three (3) liquid-tight fittings are provided pre-installed. Accepts the following cable diameters: 3/8-inch NPT fitting, 4.6 mm to 7.9 mm (0.181 in to 0.312 in); 1/2-inch NPT fittings, 4.3 mm to 11.9 mm (0.170 inch to 0.470 inch).

Window 9.5 mm (0.375 inch) polycarbonate treated with a UV light resistant coating. Viewing area: 127 mm (5 inch) diameter.

Housing Mounting Three (3) 8 mm (0.312 inch) clearance holes in base. Mounting base assembly may be rotated through 360°.

Camera Mounting Slotted internal rail assembly, which may be rotated through 360°. All camera/lens mounting hardware is provided.

Construction Extruded aluminum cover, fabricated aluminum frame, and polycarbonate window.

Finish Dark Mushroom

Dimensions (L x W x H) See Dimensional Outline. 591 x 134 x 153 mm (23.3 x 5.3 x 6.0 inch)

Weight 3.7 kg (8.2 lb)

Environmental

Temperature

External ambient temperatures of -30°C to +50°C (-22°F to +122°F)

Maintains internal temperatures of -20°C to +55°C (-4°F to +131°F)

Salt Atmosphere MIL-STD-810E, Method 509, Procedure I.

Enclosure Protection Designed to NEMA-4, IP65, Enclosure Type 4

Electromagnetic Compatibility EMC Requirements

Immunity 89/336/EEC, EN50082-1

Emission 89/336/EEC, EN50081-1 Class B

Safety

CE LVD Requirements: 73/23/EEC; EN60065

UL UL 1409

cUL CSA 22.2, No.1

Accessories

LTC 9385/00 Sunshield Provides protection from the direct rays of the sun and promotes cooling to reduce internal housing temperatures.

LTC 9380/01 Tamper Resistant Kit Includes screws and insertion tool to permit tamper resistance for up to five (5) housings.

Ordering Information

Model | Description

LTC 9385/60 Outdoor Housing for camera/lens up to 345 mm (13.6 inch), 120 VAC, 60 Hz, heater

LTC 9385/20 Outdoor Housing for camera/lens up to 345 mm (13.6 inch) 24 VAC, 50/60 Hz, heater

LTC 9385/50 Outdoor Housing for camera/lens up to 345 mm (13.6 inch), 230 VAC, 50 Hz, heater

Hardware Accessories

LTC 9385/00 Sunshield

LTC 9381/01 Conversion Kit NPT to PG

LTC 9380/00 Tamper Kit For LTC 9385 series housings, up to 10 housings

LTC 9380/01 Tamper Kit for LTC 9385 series housings, up to 5 housings

Americas:
Bosch Security Systems
130 Perinton Parkway
Fairport, New York, 14450, USA
Phone: +1 585 223 4060
Fax: +1 800 289 0096
security.sales@us.bosch.com
www.boschsecurity.us

Europe, Middle East, Africa:
Bosch Security Systems B.V.
P.O. Box 80002
5600 JB Eindhoven, The Netherlands
Phone: +31 (0) 40 27 83955
Fax: +31 (0) 40 27 86668
emea.securitysystems@bosch.com
www.boschsecurity.com

Asia-Pacific:
Bosch Security Systems Pte Ltd
38C Jalan Pemimpin
Singapore 577180
Phone: +65 6319 3450
Fax: +65 6319 3499
apr.securitysystems@bosch.com
www.boschsecurity.com

Represented by